

## Licensing Sub-Committee Report

Subject of hearing: **The Casuarina Tree, 407 London Road, Mitcham, CR4 4BG.**

Date **19 April 2024**

Time: **2.30pm**

Venue: **Virtual Meeting**

### **1. Special Policy Area (premises licences and club certificates)**

1.1 The premises are Mitcham Town Centre Cumulative Impact Zone, but the policy doesn't apply as it relates to applications for off-sales of alcohol.

### **2. Type of hearing and powers of the sub-committee**

2.1 The sub-committee is required to determine the application by taking such of the steps set out below as it considers appropriate for the promotion of the licensing objectives.

2.2 In making their determination the sub-committee must have regard to the Licensing Act 2003, the licensing objectives, guidance issued by the Secretary of State and Merton's Licensing Policy.

2.3 New premises licence: s18

(i) To grant the licence subject to conditions

(ii) To exclude from the scope of the licence any of the licensable activities to which the application relates

(iii) To refuse to specify a person in the licence as the premises supervisor

(iv) To reject the application.

### **3. Hearing papers**

3.1 The applications, notices and representations for determination by the sub-committee are contained in the hearing bundles together with any relevant existing licence. This includes any documents which must be sent to any of the parties to the hearing under Regulation 7(2) and Schedule 3 of The Licensing Act 2003 (Hearings) Regulations 2005. This bundle has been issued to all parties to the hearing.

### **4. Legal advice to the sub-committee**

4.1 A legal officer appointed by the Assistant Director of Corporate Governance and Head of Legal Services will attend the hearing to advise the sub-committee on statutory provision and legal matters.

### **5. Licensing Officer comments**

5.1 The premises is within the Mitcham Town Centre Cumulative Impact Zone, but the policy doesn't apply as it relates to applications for off-sales of alcohol.

5.2 This is an application to vary the existing premises licence, the current licence and plan are included in this report.

- 5.3 The applicant has applied to vary the plan that the premises must conform to. They have stated they wish to vary the layout of the rear garden incorporating the addition of a garden structure. They also wish to add additional conditions as listed in part M of the application form.
- 5.4 On the 20 March 2024, after consultation between the Applicant and the Metropolitan Police, we received an email, included in this report, stating that the applicant had agreed to amend the application. The amendment is as follows:
- Twelve (12) conditions to be attached to the premises licence were agreed.
- 5.5 One relevant representation regarding this application was received, from a local resident.
- 5.6 For ease, conditions that could be attached to the licence from the variation application and those agreed with the Metropolitan Police are included as an annex to this report. There is some duplication in the conditions relating to CCTV. The Sub-Committee may choose to form some conditions on the licence from these should they decide to grant the variation to the licence, if they believe they are appropriate for the promotion of the Licensing Objectives.
- 5.7 There are some conditions already attached to the premises licence and again, there is some duplication with the possible conditions that have been offered by the applicant and agreed with the Metropolitan Police. We have tried to cover these in the conditions document, in case the sub-committee wish to consolidate some of the conditions attached to the licence, but all documents that form part of this report should be considered separately.

**For enquiries about this hearing please contact**

Democratic Services  
Civic Centre  
London Road  
Morden  
SM4 5DX

**Telephone:** 020 8545 3616

**Email:** [democratic.services@merton.gov.uk](mailto:democratic.services@merton.gov.uk)

# Parties to the hearing

This document forms part of the notice of hearing.  
The following are parties to the hearing having submitted relevant applications, notices or representations under the statutory provisions indicated:

<b>Applicant</b>	
The Casuarina Tree	
<b>Statutory Authorities</b>	
<b>Interested Parties</b>	
Mr A Hogan	

**Conditions proposed by the Applicant in the application operating schedule to be attached to the premises licence.**

1. The CCTV system installed at the premises shall be maintained in effective working order and shall be in operation at all times the premises is open to the public.
2. All recordings made by the CCTV system shall be retained and stored in a suitable and secure manner for a minimum of 31 days and shall be made available on request to the Metropolitan Police, the Licensing Authority or other Responsible Authorities.
3. At all times the premises is open to the public a minimum of one member of staff on duty shall be able to operate the CCTV system.
4. Alcohol to be sold or supplied in the garden area (marked on the plan) shall only be to persons for consumption with a meal ordered at the same time, consumed with the meal and paid for together with the meal.
5. The maximum number of persons to be accommodated in the garden structure at any one time shall not exceed 60.
6. All external windows and doors to the garden structure must be kept shut at all times after 21:00. Doors may be opened for normal entrance and egress of people but must be shut immediately thereafter.  
**See condition 10. on the premises licence.**
7. Amplified music in the garden structure shall only be played through the Licence Holder's installed system.
8. Music volume and bass levels in the garden structure will be controlled only by the premises manager on duty.
9. The music volume in the garden structure shall be turned off at 23:00h and customers will be asked to leave quietly.  
**See condition 9. on the premises licence.**

**Conditions agreed with the Metropolitan Police**

Closed-circuit television

1. The premises shall install and maintain a comprehensive closed-circuit television system (CCTV). All recordings shall be stored for a minimum of 31 days with date and time stamping. Recordings shall be made available immediately upon the request of Police or authorised officer throughout the preceding 31 day period.
2. The digital CCTV will cover all areas to where public have access.

3. CCTV will be recording at all times when premises is open, and the recordings will be of evidential quality in all lighting conditions and be of a sufficient quality to produce in court of hearing.
4. All images downloaded from the CCTV must be provided in a format which can be viewed on regularly available equipment without the need for specialist software.
5. At all times the premises is open to the public a minimum of one member of staff on duty will be able to operate the CCTV.
6. The CCTV system shall be maintained in effective working order.
7. Suitable signage shall be displayed at the premises in a prominent position as customers enter the premises stating that CCTV is in operation.

#### Patrols

8. The outside area shall be monitored by staff whilst open for licensable activities to monitor intoxication levels, any crime/disorder and vulnerable customers. **See condition 6. on the premises licence. Condition 11. on the licence is regarding regulated entertainment.**

#### Welfare and Vulnerability Engagement Training

9. Customer facing staff will be provided with Welfare and Vulnerability Engagement (WAVE) training to provide those working in the licensed industry with an awareness of vulnerability and their responsibilities towards people visiting their premises.  
This training is available at  
<https://nbcc.police.uk/crimeprevention/safeguarding/welfare-andvulnerability-engagement-wave-lesson-plan?highlight=WyJ3YXZlIlI0=>

#### Security, incidents

10. An incident logbook shall be kept and maintained on the premises and made available on request to the Police or the Licensing Authority, which will record the following:
  - All crime reported to the venue
  - All ejections of patrons
  - Any complaints received
  - Any incidents of disorder
  - Any refusals to the sale of alcohol**See condition 7. on the premises licence.**

#### Dispersal

11. All staff will be trained to ask customers to leave quietly in the evening when necessary and make the request verbally where appropriate.

12. There will be appropriate signage at the premises requesting customers to leave the premises quietly. **See conditions 8. and 12. on the premises licence.**

## Application to vary a premises licence under the Licensing Act 2003

### PLEASE READ THE FOLLOWING INSTRUCTIONS FIRST

Before completing this form please read the guidance notes at the end of the form. If you are completing this form by hand please write legibly in block capitals. In all cases ensure that your answers are inside the boxes and written in black ink. Use additional sheets if necessary.

You may wish to keep a copy of the completed form for your records.

I/We Selvadurai Thevarajah and Vythilingam Nagulendran  
(Insert name(s) of applicant)

being the premises licence holder, apply to vary a premises licence under section 34 of the Licensing Act 2003 for the premises described in Part 1 below

<b>Premises licence number</b> LN/000003458
--

#### Part 1 – Premises Details

Postal address of premises or, if none, ordnance survey map reference or description			
Casuarina Tree 407 London Road			
Post town	Mitcham	Postcode	CR4 4BG

Telephone number at premises (if any)	020 8648 4868
Non-domestic rateable value of premises	£17,500

#### Part 2 – Applicant details

Daytime contact telephone number	[REDACTED]		
E-mail address (optional)	info@casuarinatree.com		
Current postal address if different from premises address	Selvadurai Thevarajah, [REDACTED] [REDACTED] Vythilingam Nagulendran, [REDACTED] [REDACTED]		
Post town		Postcode	

#### Part 3 - Variation

Please tick as appropriate

Do you want the proposed variation to have effect as soon as possible?

Yes

No

If not, from what date do you want the variation to take effect?

DD	MM	YYYY
<input type="text"/>	<input type="text"/>	<input type="text"/>

Do you want the proposed variation to have effect in relation to the introduction of the late night levy? (Please see guidance note 1)  Yes  No

**Please describe briefly the nature of the proposed variation** (Please see guidance note 2)

To vary the layout of the rear garden plan as per the plans provided incorporating the addition of a garden structure into the license. All other licensable activities, permitted hours, opening hours, and existing conditions to remain.  
To add additional conditions listed in part M.

If your proposed variation would mean that 5,000 or more people are expected to attend the premises at any one time, please state the number expected to attend:



## Part 4 Operating Schedule

Please complete those parts of the Operating Schedule below which would be subject to change if this application to vary is successful.

- | <b>Provision of regulated entertainment (Please see guidance note 3)</b>                                    | <b>Please tick all that apply</b> |
|---|-----------------------------------|
| a) plays (if ticking yes, fill in box A)  | <input type="checkbox"/>          |
| b) films (if ticking yes, fill in box B)  | <input type="checkbox"/>          |
| c) indoor sporting events (if ticking yes, fill in box C)   | <input type="checkbox"/>          |
| d) boxing or wrestling entertainment (if ticking yes, fill in box D)  | <input type="checkbox"/>          |
| e) live music (if ticking yes, fill in box E)   | <input type="checkbox"/>          |
| f) recorded music (if ticking yes, fill in box F)   | <input type="checkbox"/>          |
| g) performances of dance (if ticking yes, fill in box G)  | <input type="checkbox"/>          |
| h) anything of a similar description to that falling within (e), (f) or (g) (if ticking yes, fill in box H) | <input type="checkbox"/>          |

**Provision of late night refreshment** (if ticking yes, fill in box I)

**Supply of alcohol** (if ticking yes, fill in box J)

**In all cases complete boxes K, L and M**

A

Plays Standard days and timings (please read guidance note 8)			Will the performance of a play take place <u>indoors or outdoors or both – please tick</u> (please read guidance note 4)	Indoors	<input type="checkbox"/>
				Outdoors	<input type="checkbox"/>
				Both	<input type="checkbox"/>
Day	Start	Finish	<u>Please give further details here</u> (please read guidance note 5)  <u>State any seasonal variations for performing plays</u> (please read guidance note 6)  <u>Non standard timings. Where you intend to use the premises for the performance of plays at different times to those listed in the column on the left, please list</u> (please read guidance note 7)		
Mon					
Tue					
Wed					
Thur					
Fri					
Sat					
Sun					

B

Films Standard days and timings (please read guidance note 8)			<u>Will the exhibition of films take place indoors or outdoors or both – please tick</u> (please read guidance note 4)	Indoors	<input type="checkbox"/>			
				Outdoors	<input type="checkbox"/>			
				Both	<input type="checkbox"/>			
Day	Start	Finish	<u>Please give further details here</u> (please read guidance note 5)					
Mon								
Tue								
Wed						<u>State any seasonal variations for the exhibition of films</u> (please read guidance note 6)		
Thur								
Fri						<u>Non standard timings. Where you intend to use the premises for the exhibition of films at different times to those listed in the column on the left, please list</u> (please read guidance note 7)		
Sat								
Sun								

C

Indoor sporting events Standard days and timings (please read guidance note 8)			<u>Please give further details</u> (please read guidance note 5)
Day	Start	Finish	
Mon			<u>State any seasonal variations for indoor sporting events</u> (please read guidance note 6)
Tue			
Wed			
Thur			<u>Non standard timings. Where you intend to use the premises for indoor sporting events at different times to those listed in the column on the left, please list</u> (please read guidance note 7)
Fri			
Sat			
Sun			

D

Boxing or wrestling entertainments Standard days and timings (please read guidance note 8)			<u>Will the boxing or wrestling entertainment take place indoors or outdoors or both – please tick</u> (please read guidance note 4)	Indoors	<input type="checkbox"/>
				Outdoors	<input type="checkbox"/>
				Both	<input type="checkbox"/>
Day	Start	Finish			
Mon			<u>Please give further details here</u> (please read guidance note 5)		
Tue					
Wed			<u>State any seasonal variations for boxing or wrestling entertainment</u> (please read guidance note 6)		
Thur					
Fri			<u>Non standard timings. Where you intend to use the premises for boxing or wrestling entertainment at different times to those listed in the column on the left, please list</u> (please read guidance note 7)		
Sat					
Sun					

E

Live music Standard days and timings (please read guidance note 8)			Will the performance of live music take place <u>indoors or outdoors or both – please tick</u> (please read guidance note 4)	Indoors	<input type="checkbox"/>
				Outdoors	<input type="checkbox"/>
				Both	<input type="checkbox"/>
Day	Start	Finish	Please give further details here (please read guidance note 5)		
Mon					
Tue			State any seasonal variations for the performance of live music (please read guidance note 6)		
Wed					
Thur			Non standard timings. Where you intend to use the premises for the performance of live music at different times to those listed in the column on the left, please list (please read guidance note 7)		
Fri					
Sat					
Sun					

F

Recorded music Standard days and timings (please read guidance note 8)			<u>Will the playing of recorded music take place indoors or outdoors or both – please tick</u> (please read guidance note 4)	Indoors	<input type="checkbox"/>
				Outdoors	<input type="checkbox"/>
				Both	<input type="checkbox"/>
Day	Start	Finish	<u>Please give further details here</u> (please read guidance note 5)		
Mon					
Tue			<u>State any seasonal variations for the playing of recorded music</u> (please read guidance note 6)		
Wed					
Thur			<u>Non standard timings. Where you intend to use the premises for the playing of recorded music at different times to those listed in the column on the left, please list</u> (please read guidance note 7)		
Fri					
Sat					
Sun					

G

<b>Performances of dance</b> Standard days and timings (please read guidance note 8)			<b><u>Will the performance of dance take place indoors or outdoors or both – please tick</u></b> (please read guidance note 4)		Indoors	<input type="checkbox"/>				
					Outdoors	<input type="checkbox"/>				
					Both	<input type="checkbox"/>				
Day	Start	Finish	<b><u>Please give further details here</u></b> (please read guidance note 5)							
Mon										
Tue										
Wed							<b><u>State any seasonal variations for the performance of dance</u></b> (please read guidance note 6)			
Thur										
Fri							<b><u>Non standard timings. Where you intend to use the premises for the performance of dance at different times to those listed in the column on the left, please list</u></b> (please read guidance note 7)			
Sat										
Sun										



H

<b>Anything of a similar description to that falling within (e), (f) or (g)</b> Standard days and timings (please read guidance note 8)			Please give a description of the type of entertainment you will be providing		
Day	Start	Finish	<b><u>Will this entertainment take place indoors or outdoors or both – please tick</u></b> (please read guidance note 4)	Indoors	<input type="checkbox"/>
Mon				Outdoors	<input type="checkbox"/>
				Both	<input type="checkbox"/>
Tue			<b><u>Please give further details here</u></b> (please read guidance note 5)		
Wed					
Thur			<b><u>State any seasonal variations for entertainment of a similar description to that falling within (e), (f) or (g)</u></b> (please read guidance note 6)		
Fri					
Sat			<b><u>Non standard timings. Where you intend to use the premises for the entertainment of a similar description to that falling within (e), (f) or (g) at different times to those listed in the column on the left, please list</u></b> (please read guidance note 7)		
Sun					

I

<b>Late night refreshment</b> Standard days and timings (please read guidance note 8)			<b><u>Will the provision of late night refreshment take place indoors or outdoors or both – please tick</u></b> (please read guidance note 4)	Indoors	<input type="checkbox"/>
				Outdoors	<input type="checkbox"/>
				Both	<input type="checkbox"/>
Day	Start	Finish			
Mon			<b><u>Please give further details here</u></b> (please read guidance note 5)		
Tue					
Wed			<b><u>State any seasonal variations for the provision of late night refreshment</u></b> (please read guidance note 6)		
Thur					
Fri			<b><u>Non standard timings. Where you intend to use the premises for the provision of late night refreshment at different times, to those listed in the column on the left, please list</u></b> (please read guidance note 7)		
Sat					
Sun					

J

<b>Supply of alcohol</b> Standard days and timings (please read guidance note 8)			<b>Will the supply of alcohol be for consumption – please tick</b> (please read guidance note 9)	On the premises	<input type="checkbox"/>
				Off the premises	<input type="checkbox"/>
				Both	<input type="checkbox"/>
Day	Start	Finish	<b><u>State any seasonal variations for the supply of alcohol</u></b> (please read guidance note 6)		
Mon					
Tue					
Wed					
Thur					
Fri					
Sat					
			<b><u>Non-standard timings. Where you intend to use the premises for the supply of alcohol at different times to those listed in the column on the left, please list</u></b> (please read guidance note 7)		
Sun					

K

<p><b>Please highlight any adult entertainment or services, activities, other entertainment or matters ancillary to the use of the premises that may give rise to concern in respect of children</b> (please read guidance note 10).</p>
--

L

<b>Hours premises are open to the public</b> Standard days and timings (please read guidance note 8)			<u>State any seasonal variations</u> (please read guidance note 6)
Day	Start	Finish	
Mon			<b><u>Non standard timings. Where you intend the premises to be open to the public at different times from those listed in the column on the left, please list</u></b> (please read guidance note 7)
Tue			
Wed			
Thur			
Fri			
Sat			
Sun			

Please identify those conditions currently imposed on the licence which you believe could be removed as a consequence of the proposed variation you are seeking.

Please tick as appropriate

- I have enclosed the premises licence
- I have enclosed the relevant part of the premises licence

If you have not ticked one of these boxes, please fill in reasons for not including the licence or part of it below

Reasons why I have not enclosed the premises licence or relevant part of premises licence.

## **M**

Describe any additional steps you intend to take to promote the four licensing objectives as a result of the proposed variation:

### **a) General – all four licensing objectives (b, c, d and e) (please read guidance note 11)**

There is an existing premises licence LN/000003458 for Sale of Alcohol for on and off the premises, Late Night Refreshment, Indoor Sporting Events, Live Music, Recorded Music and Performance of Dance.

The varied licence will only change the plan of the rear garden.

### **b) The prevention of crime and disorder**

1. The CCTV system installed at the premises shall be maintained in effective working order and shall be in operation at all times the premises is open to the public.
2. All recordings made by the CCTV system shall be retained and stored in a suitable and secure manner for a minimum of 31 days, and shall be made available on request to the Metropolitan Police, the Licensing Authority or other Responsible Authorities.
3. At all times the premises is open to the public a minimum of one member of staff on duty will be able to operate the CCTV system.
4. Alcohol shall be sold or supplied in the garden area (marked on the plan attached) only to persons with and for consumption at a meal supplied at the same time, consumed with the meal and paid for together with the meal.

### **c) Public safety**

1. The maximum number of persons to be accommodated in the garden structure at any one time shall not exceed 60.

### **d) The prevention of public nuisance**

- 4 All external windows and doors to the garden structure must be kept shut at all times after 21:00. Doors may be opened for normal entrance and egress of people but must be shut immediately thereafter.
5. Amplified music in the garden structure will only be played through the Licence Holder's installed system.
9. Music volume and bass levels in the garden structure will be controlled only by the premises manager on duty.
10. The music volume in the garden structure shall be turned off at 23:00h and customers will be asked to leave quietly .

### **e) The protection of children from harm**

e) The protection of children from harm

Checklist:

Please tick to indicate agreement

- I have made or enclosed payment of the fee; or
- I have not made or enclosed payment of the fee because this application has been made in relation to the introduction of the late night levy.
- I have sent copies of this application and the plan to responsible authorities and others where applicable.
- I understand that I must now advertise my application.
- I have enclosed the premises licence or relevant part of it or explanation.
- I understand that if I do not comply with the above requirements my application will be rejected.

**IT IS AN OFFENCE, UNDER SECTION 158 OF THE LICENSING ACT 2003, TO MAKE A FALSE STATEMENT IN OR IN CONNECTION WITH THIS APPLICATION. THOSE WHO MAKE A FALSE STATEMENT MAY BE LIABLE ON SUMMARY CONVICTION TO A FINE OF ANY AMOUNT.**

**Part 5 – Signatures** (please read guidance note 12)

**Signature of applicant (the current premises licence holder) or applicant’s solicitor or other duly authorised agent** (please read guidance note 13). **If signing on behalf of the applicant, please state in what capacity.**

Signature	X <span style="background-color: black; color: black;">[REDACTED]</span>
Date	X 09.02.2024
Capacity	

**Where the premises licence is jointly held, signature of 2nd applicant (the current premises licence holder) or 2nd applicant’s solicitor or other authorised agent** (please read guidance note 14). **If signing on behalf of the applicant, please state in what capacity.**

Signature	X	[REDACTED]
Date	X 09.02.2004	
Capacity		

<b>Contact name (where not previously given) and address for correspondence associated with this application (please read guidance note 15)</b>			
Post town		Post code	
Telephone number (if any)			
If you would prefer us to correspond with you by e-mail, your e-mail address (optional)			

#### Notes for Guidance

**This application cannot be used to vary the licence so as to extend the period for which the licence has effect or to vary substantially the premises to which it relates. If you wish to make that type of change to the premises licence, you should make a new premises licence application under section 17 of the Licensing Act 2003.**

1. You do not have to pay a fee if the only purpose of the variation for which you are applying is to avoid becoming liable for the late night levy
2. Describe the premises. For example, the type of premises, its general situation and layout and any other information which could be relevant to the licensing objectives. Where your application includes off-supplies of alcohol and you intend to provide a place of consumption of these off-supplies of alcohol, you must include a description of where the place will be and its proximity to the premises.
3. In terms of specific regulated entertainments please note that:
  - Plays: no licence is required for performances between 08.00 and 23.00 on any day, provided that the audience does not exceed 500.
  - Films: no licence is required for 'not-for-profit' film exhibition held in community premises between 08.00 and 23.00 on any day provided that the audience does not exceed 500 and the organiser (a) gets consent to the screening from a person who is responsible for the premises; and (b) ensures that each such screening abides by age classification ratings.
  - Indoor sporting events: no licence is required for performances between 08.00 and 23.00 on any day, provided that the audience does not exceed 1000.
  - Boxing or Wrestling Entertainment: no licence is required for a contest, exhibition or display of Greco-Roman wrestling, or freestyle wrestling between 08.00 and 23.00 on any day, provided that the audience does not exceed 1000. Combined fighting sports – defined as a contest, exhibition or display which combines boxing or wrestling with one or more martial arts – are licensable as a boxing or wrestling entertainment rather than an indoor sporting event.
  - Live music: no licence permission is required for:



North

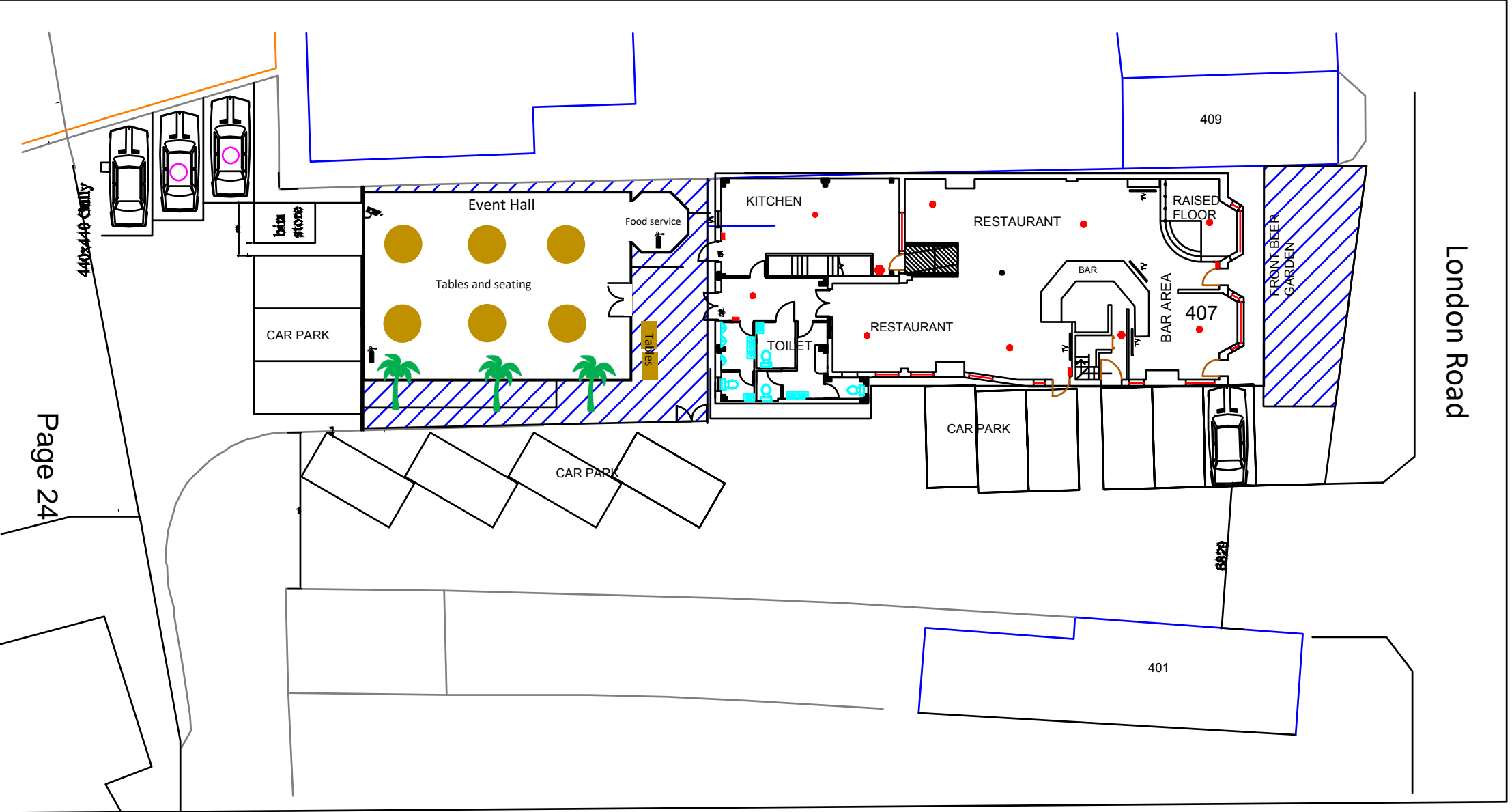

Page 24

SCALE 1:200

- SMOKE DETECTOR
- CALL POINT
- ◆ FIRE EXTINGUISHER

CASUARINA TREE  
 407, LONDON ROAD  
 MITCHAM.  
 CR44BA

8/2/2024





## LICENSING ACT 2003

### Part A Premises licence

Premises licence number

LN/000003458

#### Part 1 - Premises details

Postal address of premises, or if none, ordnance survey map reference or description

**Casuarina Tree  
407 London Road  
Mitcham  
CR4 4BG**

**020 8648 4868**

Where the licence is time limited, the dates

**Not applicable**

The opening hours of the premises

<b>Monday</b>	<b>06:00</b>	<b>-</b>	<b>00:30</b>
<b>Tuesday</b>	<b>06:00</b>	<b>-</b>	<b>00:30</b>
<b>Wednesday</b>	<b>06:00</b>	<b>-</b>	<b>00:30</b>
<b>Thursday</b>	<b>06:00</b>	<b>-</b>	<b>00:30</b>
<b>Friday</b>	<b>06:00</b>	<b>-</b>	<b>02:30</b>
<b>Saturday</b>	<b>06:00</b>	<b>-</b>	<b>02:30</b>
<b>Sunday</b>	<b>06:00</b>	<b>-</b>	<b>00:30</b>

**New Year's Eve 06.00 - 03.00.**

Sale & supplies of alcohol, whether these are on and/or off supplies

**On and Off the premises**



## Licensable activities and permitted times authorised by the licence

### Alcohol Sales

#### On and Off the premises

Monday	10:00	-	00:00
Tuesday	10:00	-	00:00
Wednesday	10:00	-	00:00
Thursday	10:00	-	00:00
Friday	10:00	-	02:00
Saturday	10:00	-	02:00
Sunday	10:00	-	00:00

New Year's Eve 08.00 - 02.00.

### Indoor Sporting Events

#### Indoors

Monday	08:00	-	00:00
Tuesday	08:00	-	00:00
Wednesday	08:00	-	00:00
Thursday	08:00	-	00:00
Friday	08:00	-	02:00
Saturday	08:00	-	02:00
Sunday	08:00	-	00:00

New Year's Eve 08.00 - 02.00.



### Live Music

#### Indoors

Monday	08:00	-	00:00
Tuesday	08:00	-	00:00
Wednesday	08:00	-	00:00
Thursday	08:00	-	00:00
Friday	08:00	-	02:00
Saturday	08:00	-	02:00
Sunday	08:00	-	00:00

New Year's Eve 8.00 - 03.00.

### Recorded Music

#### Indoors

Monday	08:00	-	00:00
Tuesday	08:00	-	00:00
Wednesday	08:00	-	00:00
Thursday	08:00	-	00:00
Friday	08:00	-	02:00
Saturday	08:00	-	02:00
Sunday	08:00	-	00:00

New Year's Eve 8.00 - 03.00.

### Performance of Dance

#### Indoors

Monday	08:00	-	00:00
Tuesday	08:00	-	00:00
Wednesday	08:00	-	00:00
Thursday	08:00	-	00:00
Friday	08:00	-	02:00
Saturday	08:00	-	02:00
Sunday	08:00	-	00:00



**New Year's Eve 08:00 - 02:00.**

**Late Night Refreshment**

**Indoors**

<b>Monday</b>	<b>23:00</b>	<b>-</b>	<b>00:00</b>
<b>Tuesday</b>	<b>23:00</b>	<b>-</b>	<b>00:00</b>
<b>Wednesday</b>	<b>23:00</b>	<b>-</b>	<b>00:00</b>
<b>Thursday</b>	<b>23:00</b>	<b>-</b>	<b>00:00</b>
<b>Friday</b>	<b>23:00</b>	<b>-</b>	<b>01:00</b>
<b>Saturday</b>	<b>23:00</b>	<b>-</b>	<b>01:00</b>
<b>Sunday</b>	<b>23:00</b>	<b>-</b>	<b>00:00</b>

**New Year's Eve 23.00 - 02.00.**

## Part 2

Name, (registered) address, telephone number of holder(s) of premises licence

**Selvadurai Thevarajah**

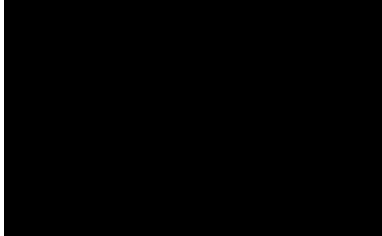

**Vythilingam Nagulendran**

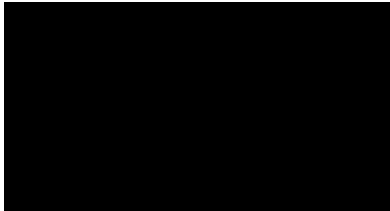

Registered number of holder, ie company number, charity number etc.

**None**

Name, address and telephone number of designated premises supervisor where the premises licence authorises for the supply of alcohol

**Selvadurai Thevarajah**

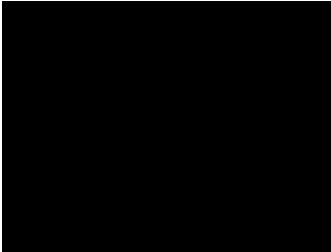

ENVIRONMENT AND REGENERATION DEPARTMENT  
Licensing Team  
London Borough of Merton  
14<sup>th</sup> Floor, Merton Civic Centre  
London Road  
Morden, Surrey  
SM4 5DX

Tel: 020 8274 4901  
[www.merton.gov.uk/licensing](http://www.merton.gov.uk/licensing)



Issuing authority and licence number of personal licence held by designated premises supervisor where the premises licence authorises for the supply of alcohol

**London Borough of Bromley 0502260LAPER**

## ANNEX 1 TABLE OF MANDATORY CONDITIONS UNDER THE LICENSING ACT 2003

1. That no supply of alcohol may be made under the premises licence  
(a) at a time when there is no designated premises supervisor in respect of the premises licence, or  
(b) at a time when the designated premises supervisor does not hold a personal licence or his personal licence is suspended.
2. That every supply of alcohol under the premises licence must be made or authorised by a person who holds a personal licence.
3. Where one or more individuals must be at the premises to carry out a security activity, each such individual must be licensed by the Security Industry Authority by a licence granted under the Private Security Industry Act 2001 or entitled to carry out that activity by virtue of section 4 of the Private Security Industry Act 2001.
4. (1) The responsible person must ensure that staff on relevant premises do not carry out, arrange or participate in any irresponsible promotions in relation to the premises.  
  
(2) In this paragraph, an irresponsible promotion means any one or more of the following activities, or substantially similar activities, carried on for the purpose of encouraging the sale or supply of alcohol for consumption on the premises –
  - (a) games or other activities which require or encourage, or are designed to require or encourage, individuals to –
    - i. drink a quantity of alcohol within a time limit (other than to drink alcohol sold or supplied on the premises before the cessation of the period in which the responsible person is authorised to sell or supply alcohol), or
    - ii. drink as much alcohol as possible (whether within a time limit or otherwise);
  - (b) provision of unlimited or unspecified quantities of alcohol free or for a fixed or discounted fee to the public or to a group defined by a particular characteristic in a manner which carries a significant risk of undermining a licensing objective;
  - (c) provision of free or discounted alcohol or any other thing as a prize to encourage or reward the purchase and consumption of alcohol over a period of 24 hours or less in a manner which carries a significant risk of undermining a licensing objective;
  - (d) selling or supplying alcohol in association with promotional posters or flyers on, or in the vicinity of, the premises which can reasonably be considered to condone, encourage or glamorise anti-social behaviour or to refer to the effects of drunkenness in any favourable manner;
  - (e) dispensing alcohol directly by one person into the mouth of another (other than where that other person is unable to drink without assistance by reason of disability).



**5.** The responsible person must ensure that free potable water is provided on request to customers where it is reasonably available.

**6.** (1) The premises licence holder or club premises certificate holder must ensure that an age verification policy is adopted in respect of the premises in relation to the sale or supply of alcohol.

(2) The designated premises supervisor in relation to the premises licence must ensure that the supply of alcohol at the premises is carried on in accordance with the age verification policy.

(3) The policy must require individuals who appear to the responsible person to be under 18 years of age (or such older age as may be specified in the policy) to produce on request, before being served alcohol, identification bearing their photograph, date of birth and either -

- (a) a holographic mark, or
- (b) an ultraviolet feature.

**7.** The responsible person must ensure that -

(a) where any of the following alcoholic drinks is sold or supplied for consumption on the premises (other than alcoholic drinks sold or supplied having been made up in advance ready for sale or supply in a securely closed container) it is available to customers in the following measures -

- (i) beer or cider: ½ pint;
- (ii) gin, rum, vodka or whisky: 25 ml or 35 ml; and
- (iii) still wine in a glass: 125 ml;

(b) these measures are displayed in a menu, price list or other printed material which is available to customers on the premises; and

(c) where a customer does not in relation to a sale of alcohol specify the quantity of alcohol to be sold, the customer is made aware that these measures are available.

**8.** A relevant person shall ensure that no alcohol is sold or supplied for consumption on or off the premises for a price which is less than the permitted price.

**9.** For the purposes of the condition set out in paragraph 1—

(a) “duty” is to be construed in accordance with the Alcoholic Liquor Duties Act 1979;

(b) “permitted price” is the price found by applying the formula—

$$P = D + (D \times V)$$

where -

(i) P is the permitted price,

(ii) D is the amount of duty chargeable in relation to the alcohol as if the duty were charged on the date of the sale or supply of the alcohol, and

(iii) V is the rate of value added tax chargeable in relation to the alcohol as if the value added tax were charged on the date of the sale or supply of the alcohol;

(c) “relevant person” means, in relation to premises in respect of which there is in force a premises licence—

(i) the holder of the premises licence,

(ii) the designated premises supervisor (if any) in respect of such a licence, or





(iii) the personal licence holder who makes or authorises a supply of alcohol under such a licence;

(d) “relevant person” means, in relation to premises in respect of which there is in force a club premises certificate, any member or officer of the club present on the premises in a capacity which enables the member or officer to prevent the supply in question; and

(e) “value added tax” means value added tax charged in accordance with the Value Added Tax Act 1994.

Where the permitted price given by paragraph (b) of paragraph 2 would (apart from this paragraph) not be a whole number of pennies, the price given by that sub-paragraph shall be taken to be the price actually given by that sub-paragraph rounded up to the nearest penny.

Sub-paragraph (2) applies where the permitted price given by Paragraph (b) of paragraph 2 on a day (“the first day”) would be different from the permitted price on the next day (“the second day”) as a result of a change to the rate of duty or value added tax.

The permitted price which would apply on the first day applies to sales or supplies of alcohol which take place before the expiry of the period of 14 days beginning on the second day.

**10.** The admission of children to the exhibition of any film is to be restricted in accordance with any recommendation made by the relevant film classification body or relevant licensing authority.

**11.** No condition may be attached to the licence as to the nature of the plays which may be performed, or the manner of performing plays, under a licence that permits the performance of plays.

## Annex 2 Conditions consistent with the Operating Schedule

1. Challenge 25 policy will be adopted at the premises.
2. Alcohol not to be consumed anywhere on premises by anyone under 18 years old, regardless of whether or not they are taking a meal with an adult.
3. Alcohol must not be sold for consumption in the hotel rooms.
4. All staff to receive regular, Police supported training in relation to under age sales and awareness of Children at Risk of Sexual Exploitation.
5. Alcohol off-sales to only be for consumption within the confines of the gardens and grounds controlled by the premises, with the exception of the hotel rooms and corridors.
6. After 23:00 patrols shall address noisy patrons outside the premises.
7. A logbook shall be kept to record such patrols and incidents and shall be made available for inspection by Council Officers.
8. Clear signs that are a minimum A4 size shall be placed at exit points stating "This is a residential area please leave quietly".
9. Patrons shall not use the rear external area after 23:00.
10. All doors and windows apart from access and egress are kept shut whilst regulated entertainment is being provided at the premises.
11. Whilst regulated entertainment is provided, patrols will take place on an hourly basis at the perimeter of the property to ensure that there is no sound escape. Any sound escape from the property shall be addressed immediately and reduced to a level that is not audible at the nearest residential property.
12. Clear signs that are a minimum A4 size are placed at exit points stating "This is a residential area please leave quietly".

## Annex 3 Conditions attached after a hearing by the licensing authority

NOT APPLICABLE

## Annex 4

Premises Plan: Drawing 'Casuarina Tree' of 16/04/2018.

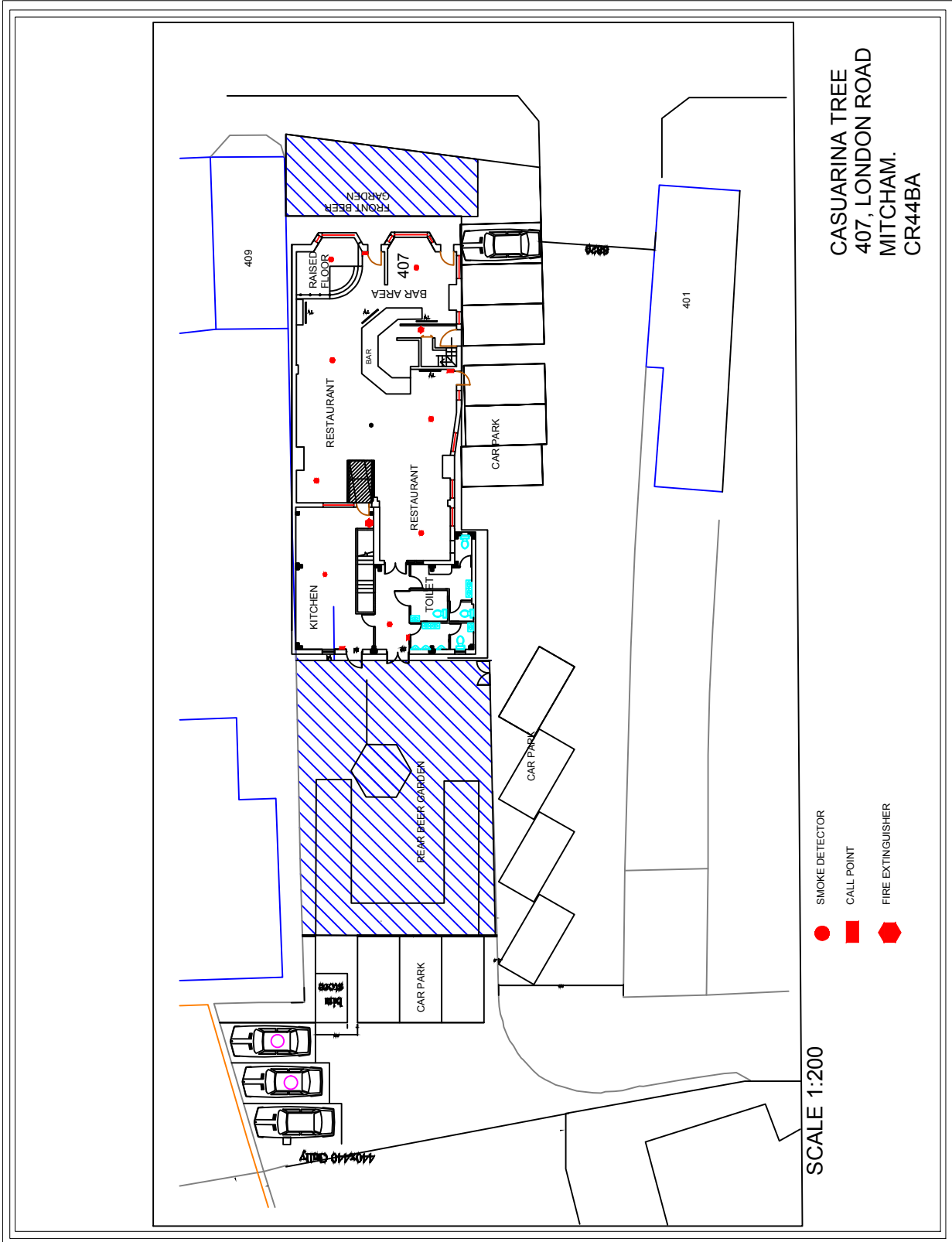

To whom this may concern. I and other residents that live adjacent to the back of the casuarina tree/pub/ restaurant/hotel object to the owners being given permission to allow the wooden structure to be used for parties and other activities. The reason being, the close proximity of residential homes and effects it will have on residents. Many have young children who need sleep and peace quiet at night, also the parents need to be considered, and then there are elderly residents to who have a right to peace and quiet at all times. If they are given permission I think there will be many problems. With regards Mr A Hogan